



# Illustrated Parts List

## Model Series

# 217800

TYPE NUMBER  
0111 through 0439.

### TABLE OF CONTENTS

<b>Air Cleaner</b> .....	7
<b>Alternator</b> .....	10
<b>Blower Housing</b> .....	7
<b>Camshaft</b> .....	3
<b>Carburetor</b> .....	5, 6
<b>Controls</b> .....	9
<b>Crankshaft</b> .....	3
<b>Cylinder</b> .....	2
<b>Cylinder Head</b> .....	4
<b>Electric Starter</b> .....	8
<b>Engine Sump</b> .....	2
<b>Exhaust System</b> .....	7
<b>Flywheel</b> .....	8
<b>Fuel System</b> .....	9
<b>Gasket Set - Engine</b> .....	4
<b>Gasket Set - Valve</b> .....	4
<b>Governor Spring</b> .....	9
<b>Ignition</b> .....	9
<b>Intake Manifold</b> .....	4
<b>Kit - Carburetor Overhaul</b> .....	5
<b>Lubrication</b> .....	3
<b>Operator's Manual</b> .....	2
<b>Piston, Rings, Connecting Rod</b> .....	3
<b>Rewind Starter</b> .....	8
<b>Valves</b> .....	4
<b>Warning Label</b> .....	2

PRINTED IN U.S.A.



COPYRIGHT by BRIGGS & STRATTON CORPORATION  
All rights reserved. No part of this material may be reproduced or transmitted, in any form or by any means, electronic or mechanical, including photocopying, recording or by any information storage and retrieval system, without permission in writing from Briggs & Stratton Corporation.

1058 OPERATOR'S MANUAL

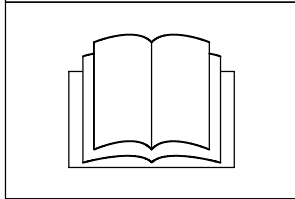

1319 WARNING LABEL

**WARNING**

- Read and follow Operating Instructions before running engine.
- Gasoline is flammable. Allow engine to cool at least 2 minutes before refueling.
- Engines emit carbon monoxide, **DO NOT** run in enclosed area.
- Muffler area temperature may exceed 150°F. Do not touch hot parts.

**REQUIRED** when replacing parts with warning labels affixed.

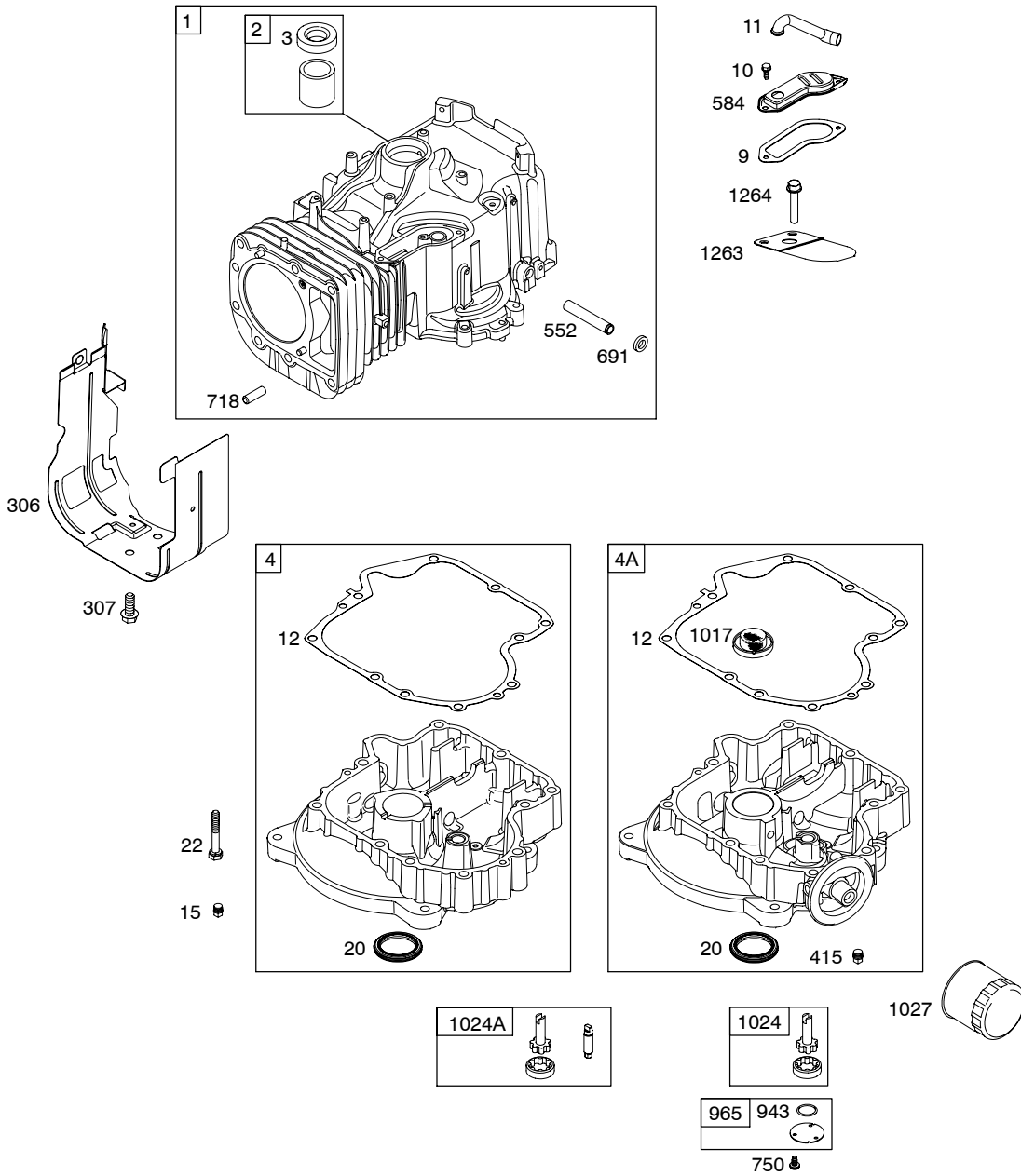

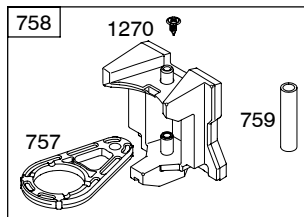
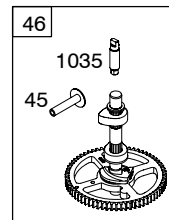
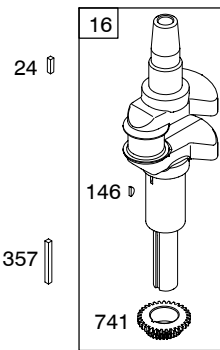
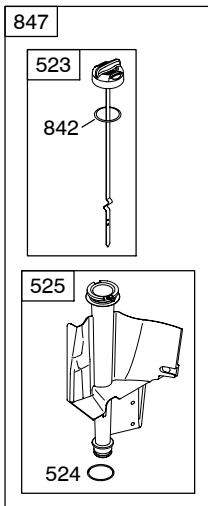
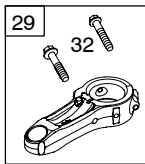
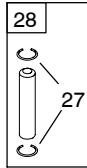
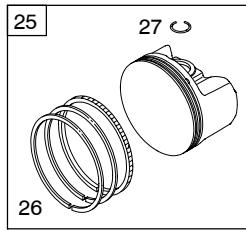

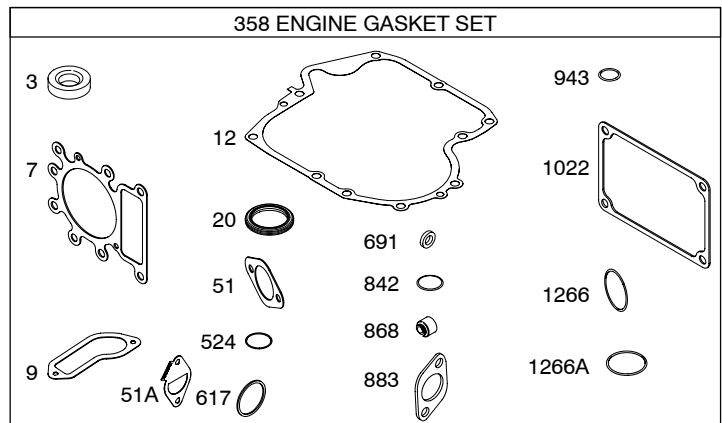
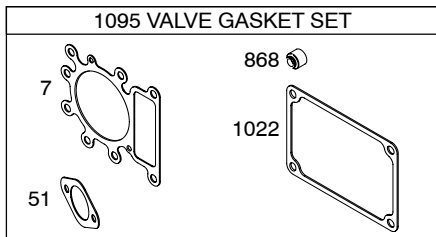
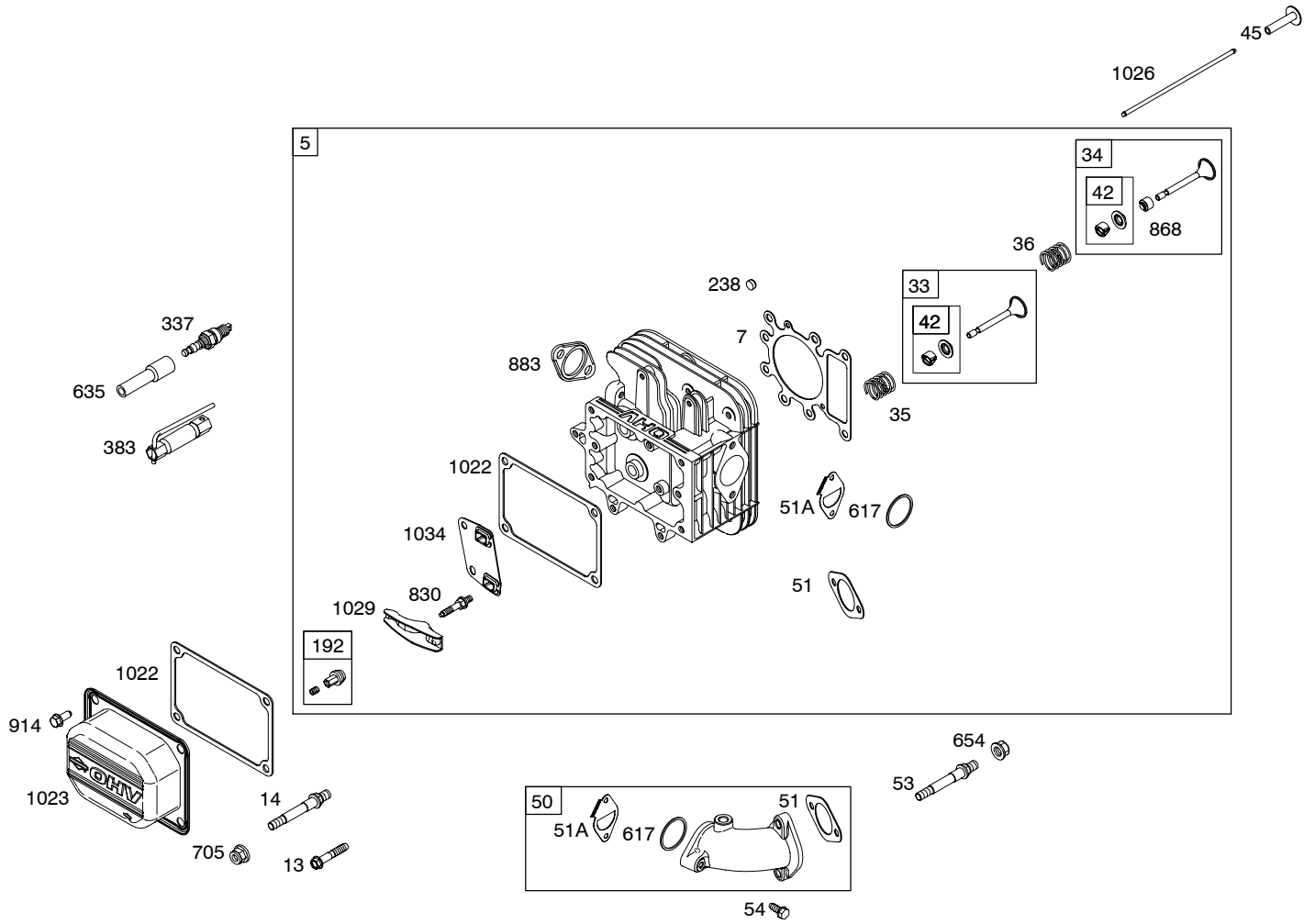

**Illustrations cover a range of engines. Parts shown without corresponding text may not be used on your specific engine.**  
**5498-4** Assemblies include all parts shown in frames. **06/18/2007**

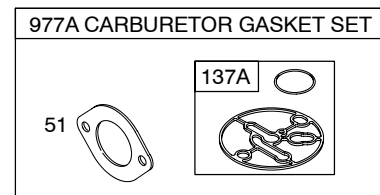
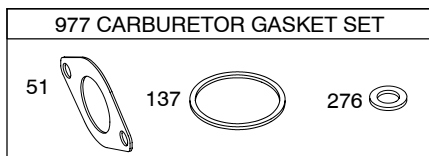
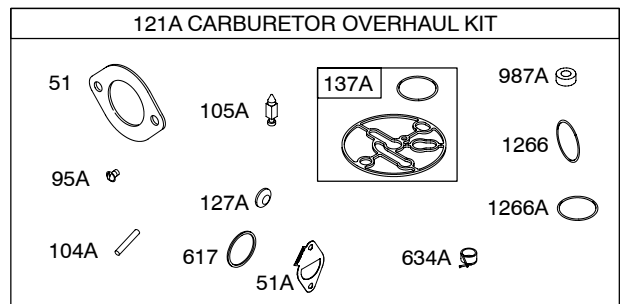
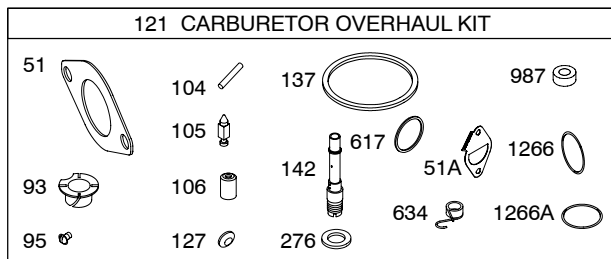
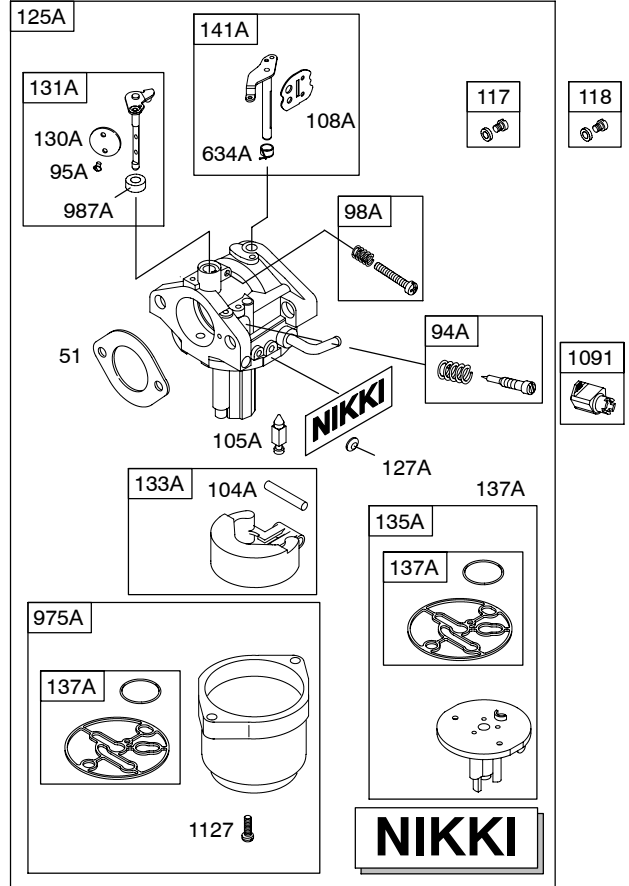
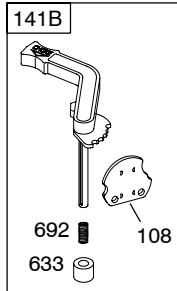
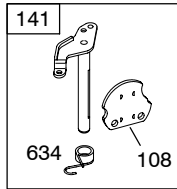
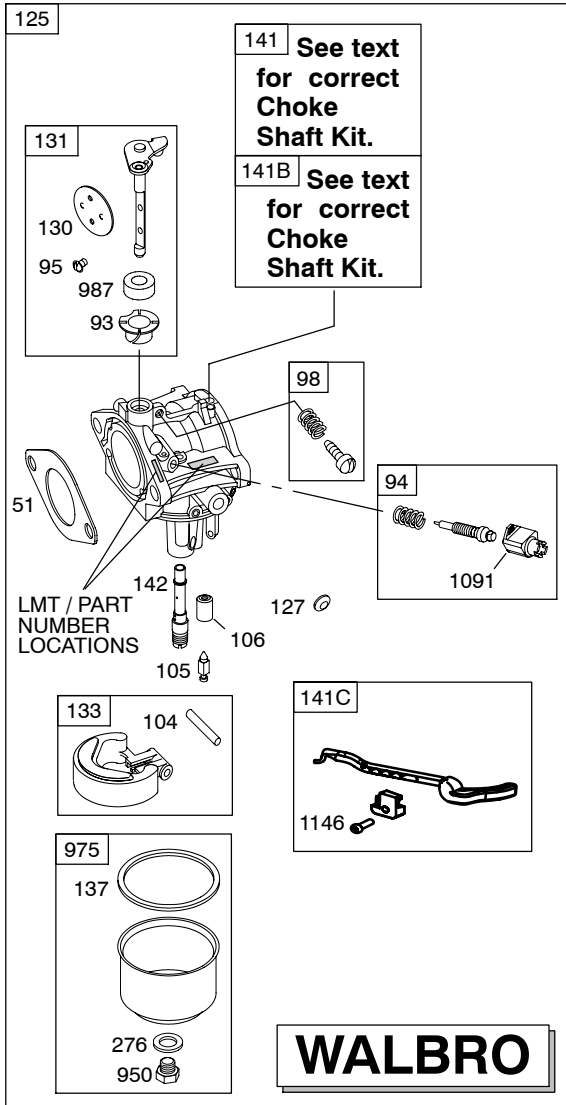

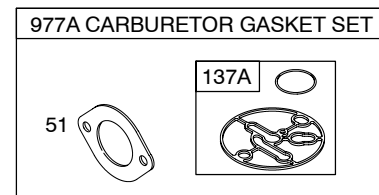
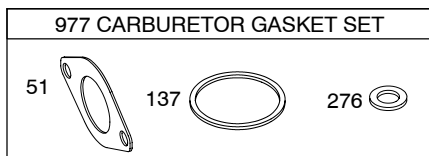
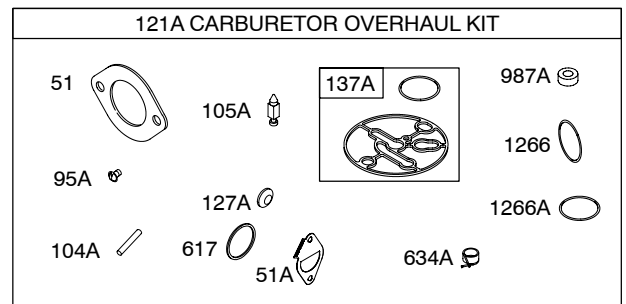
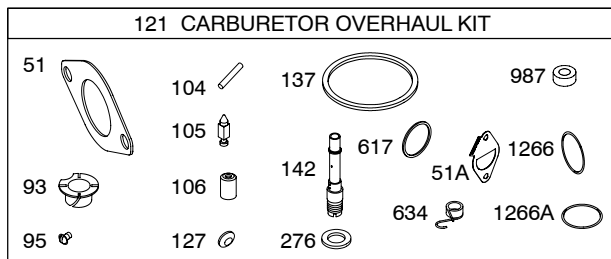
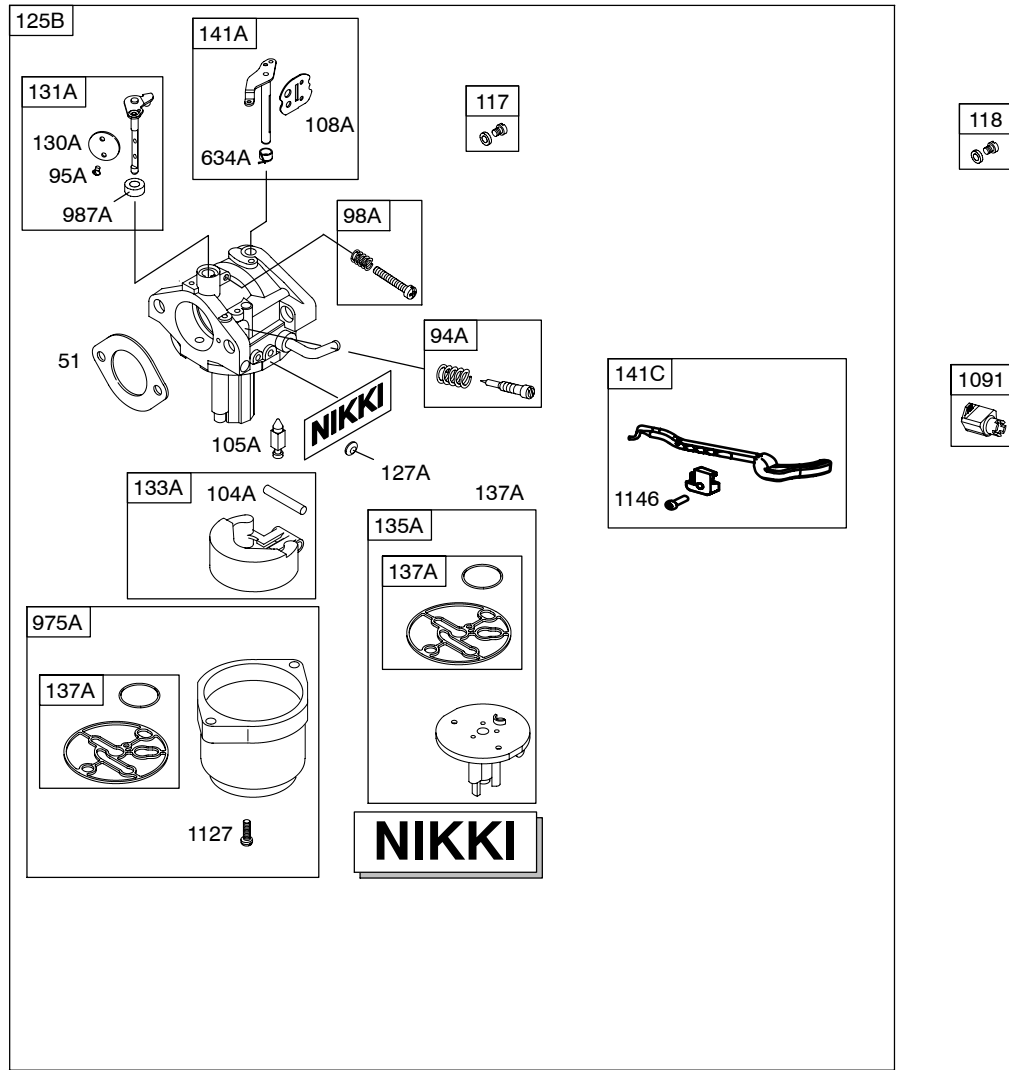

**Illustrations cover a range of engines. Parts shown without corresponding text may not be used on your specific engine.**  
**5498-6** Assemblies include all parts shown in frames. **06/18/2007**

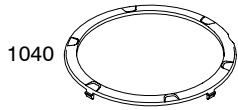

1036 EMISSIONS LABEL

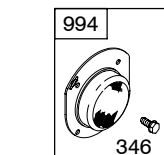
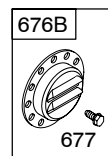
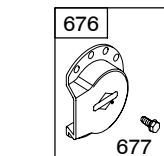
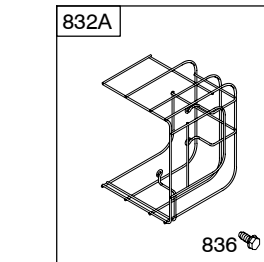
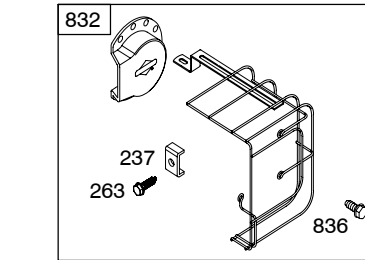
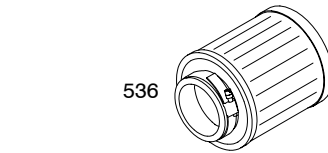
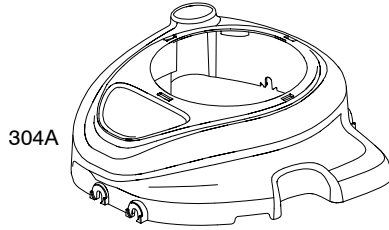
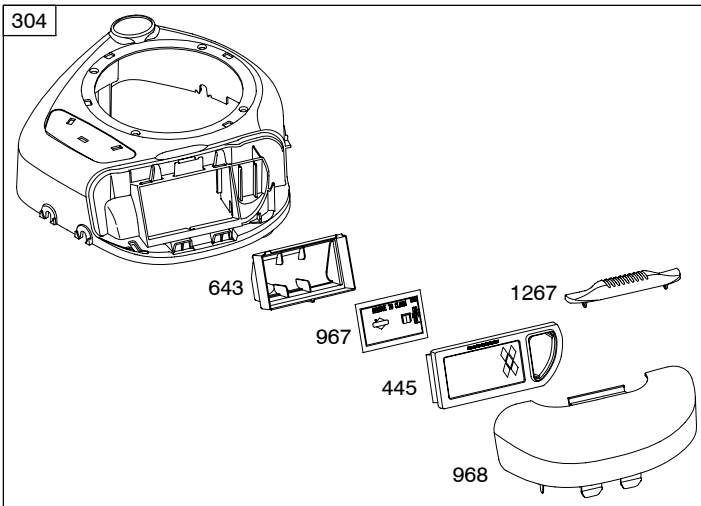

305A  
305

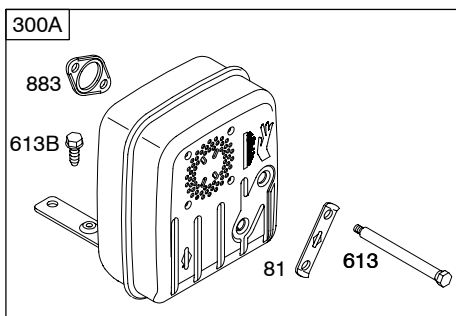
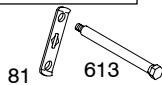
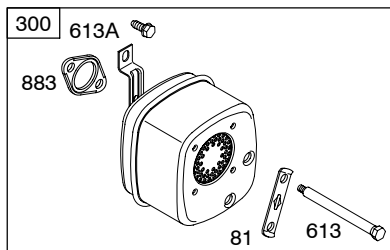
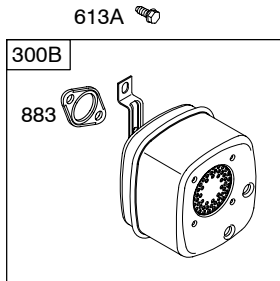
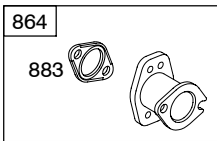
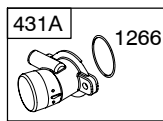
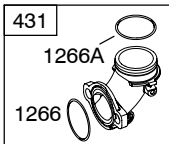

Illustrations cover a range of engines. Parts shown without corresponding text may not be used on your specific engine.  
5498-7 Assemblies include all parts shown in frames. 06/18/2007

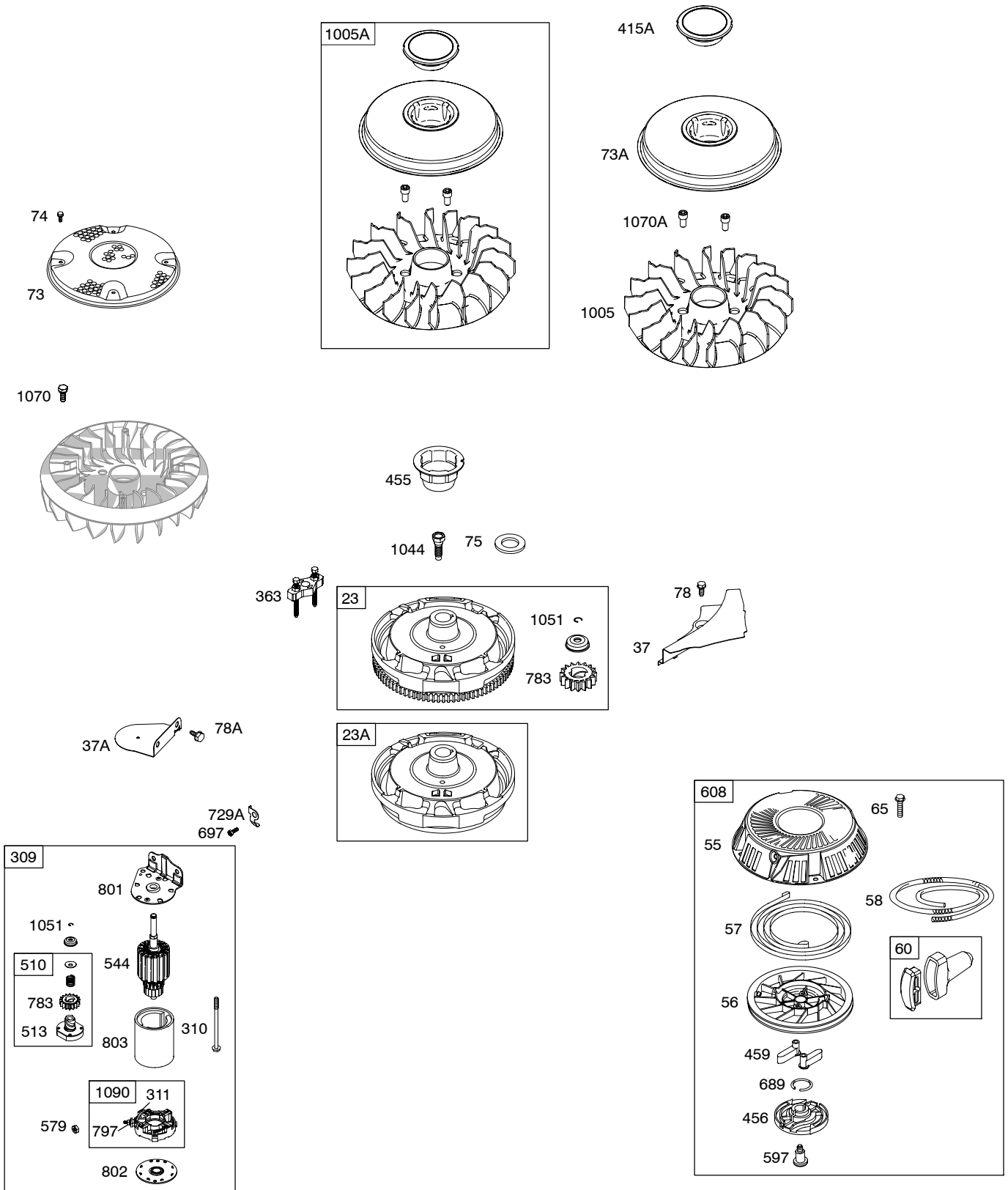





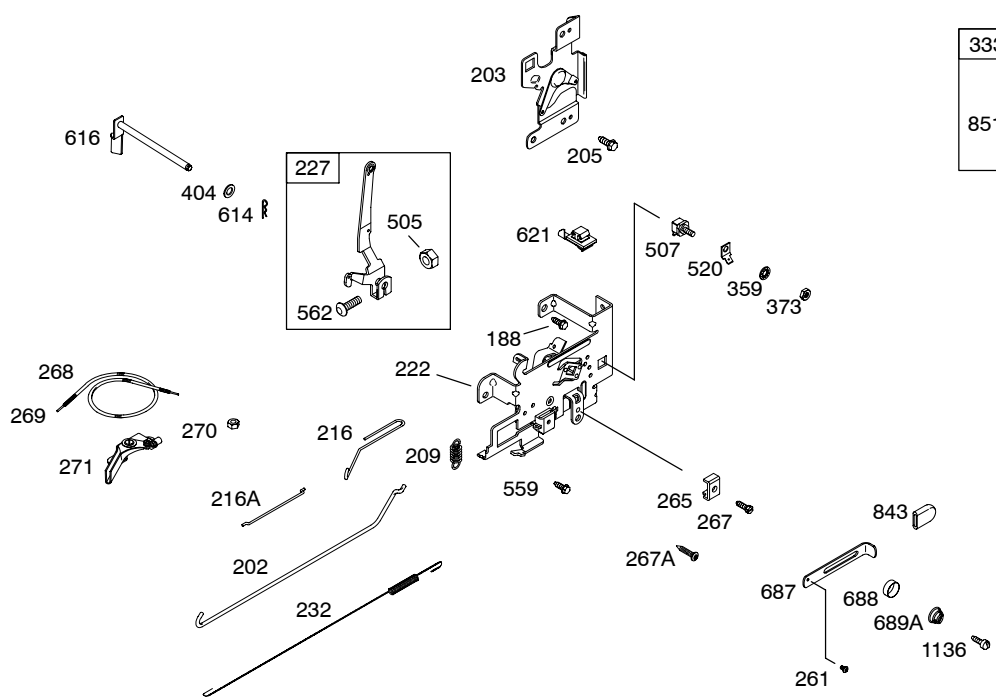
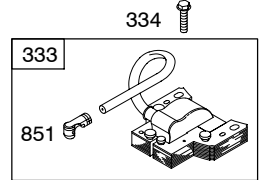
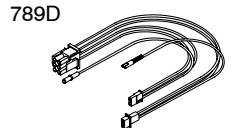
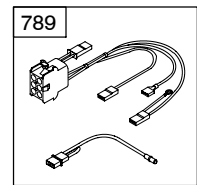
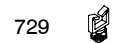
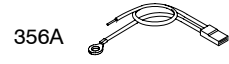
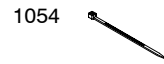
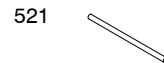
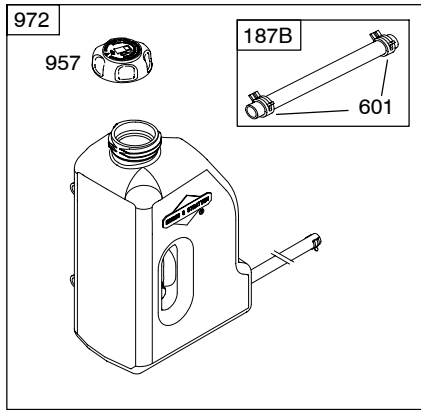
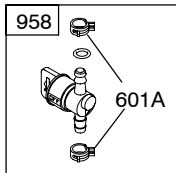
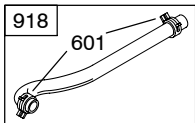
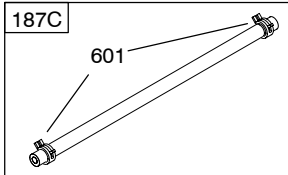
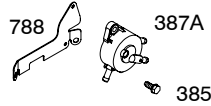
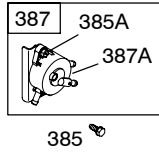
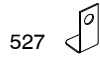
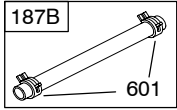
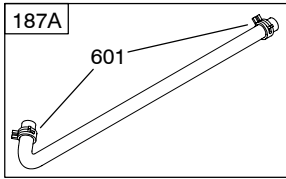
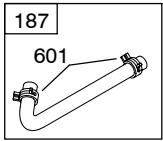

Illustrations cover a range of engines. Parts shown without corresponding text may not be used on your specific engine.  
 5498-8 Assemblies include all parts shown in frames. 06/18/2007



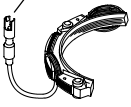

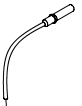
**Illustrations cover a range of engines. Parts shown without corresponding text may not be used on your specific engine.**  
**5498-9** Assemblies include all parts shown in frames. **06/18/2007**

DC ONLY		DUAL CIRCUIT	
474A	1059	474B	1059
877A		877	
			
	578 		878 

**NOTE:** All stators use a No. 1119 mounting screw. 

**NOTE:** The proper flywheel part number and/or the alternator magnet size will determine the alternator type or output. See repair instruction manual for additional information.



# 217800

REF. NO.	PART NO.	DESCRIPTION	REF. NO.	PART NO.	DESCRIPTION	REF. NO.	PART NO.	DESCRIPTION
33	791934	Valve-Exhaust (Used After Code Date 06120300). ----- Note ----- 695760 Valve-Exhaust (Used Before Code Date 06120400).	73A	7794437	Screen-Rotating (Used After Code Date 07040800).	118	791405	Jet-Main (High Altitude) (Carburetor 793362) ----- Note ----- 699898 Jet-Main (High Altitude) (Carburetor 698944 and 698945)
34	791935	Valve-Intake (Used After Code Date 06120300). ----- Note ----- 695761 Valve-Intake (Used Before Code Date 06120400).	74	697897	Screw (Rotating Screen) (Used Before Code Date 07040900).	118		Jet-Main (High Altitude) (Carburetor 698944 and 698945)
35	691279	Spring-Valve (Intake)	75	690582	Washer (Flywheel)	121	790031	Kit-Carburetor Overhaul (Walbro)
36	691279	Spring-Valve (Exhaust)	78	691003	Screw (Flywheel Guard)	121A	698787	Kit-Carburetor Overhaul (Nikki)
37	697352	Guard-Flywheel	78A	690364	Screw (Flywheel Guard)	125	793227	Carburetor (Walbro)(Gravity Feed)(Manual Choke) Used on Type No(s). 0114.
37A	697626	Guard-Flywheel Used on Type No(s). 0113, 0114, 0115, 0117, 0121, 0138, 0143, 0145.	81	691178	Lock-Muffler Screw	125A	794653	Carburetor (Nikki)(Gravity Feed) Used on Type No(s). 0113, 0125, 0138, 0142, 0144, 0381, 0382, 0393, 0426, 0439.
42	499586	Keeper-Valve	81	691178	Lock-Muffler Screw			----- Note ----- 791266 Carburetor (Nikki)(Pump Feed) Used on Type No(s). 0111, 0115, 0117, 0118, 0119, 0121, 0143.
43	691968	Slinger-Governor/Oil	93	690602	Bushing-Throttle Shaft	125B	794215	Carburetor (Nikki)(Gravity Feed) Used on Type No(s). 0145.
45	690564	Tappet-Valve	94	498030	Kit-Idle Mixture (Walbro)	127	694524	Plug-Welch (Walbro)
46	793583	Camshaft	94A	695425	Kit-Idle Mixture (Nikki)	127A	690727	Plug-Welch (Nikki)
50	697361	Manifold-Intake	95	691636	Screw (Throttle Valve) (Walbro)	130	790024	Valve-Throttle (Walbro)
51★◆△	692137	Gasket-Intake	95A	690718	Screw (Throttle Valve)	130A	698774	Valve-Throttle (Nikki)
51A★◆△	794312	Gasket-Intake (Used After Code Date 07040200).	98	495800	Kit-Idle Speed (Walbro)	131	790901	Kit-Throttle Shaft (Walbro)
53	690227	Stud (Carburetor)	98A	695408	Kit-Idle Speed (Nikki)			
54	691148	Screw (Intake Manifold)	104	690525	Pin-Float Hinge (Walbro)			
55	695130	Housing-Rewind Starter	104A	694918	Pin-Float Hinge (Nikki)			
56	695129	Pulley-Starter	105	231855s	Valve-Float Needle (Walbro)			
57	695131	Spring-Rewind Starter	105A	696136	Valve-Float Needle (Nikki)			
58	695132	Rope-Starter	106	690577	Seat-Inlet (Walbro)(Gravity Feed) ----- Note ----- 691780 Seat-Inlet (Walbro)(Pump Feed)			
60	494212	Grip-Starter Rope	108	691227	Valve-Choke (Walbro)			
65	690759	Screw (Rewind Starter) (Used After Code Date 07040800). ----- Note ----- 697725 (Rewind Starter) (Used Before Code Date 07040900).	108A	698773	Valve-Choke (Nikki)			
73	697133	Screen-Rotating (Used Before Code Date 07040900).	117	794258	Jet-Main (Standard)(Carburetor 793362) ----- Note ----- 699897 Jet-Main (Standard)(Carburetor 698944 and 698945)			

★ Included in Engine Gasket Set-Ref. No. 358.

◆ Included in Carburetor Overhaul Kit-Ref. No. 121 or 121A.

◆ Included in Carburetor Gasket Set-Ref. No. 977 or 977A.

△ Included in Valve Gasket Set-Ref. No. 1095.

**Illustrations cover a range of engines. Parts shown without corresponding text may not be used on your specific engine.**

REF. NO.	PART NO.	DESCRIPTION	REF. NO.	PART NO.	DESCRIPTION	REF. NO.	PART NO.	DESCRIPTION
131A	698776	Kit-Throttle Shaft (Nikki)	205	691693	Screw (Bell Crank)	232	691842	Spring-Governor Link
133	494381	Float-Carburetor (Walbro)	209	792813	Spring-Governor (Brown)	237	690409	Retainer-Muffler Guard
133A	694914	Float-Carburetor (Nikki)			Used on Type No(s). 0111, 0113, 0114, 0118, 0125, 0145.			Used on Type No(s). 0114, 0117, 0119, 0125, 0143, 0145.
135A	698780	Tube-Fuel Transfer (Nikki)(Gravity Feed)			----- Note -----	238	691843	Cap-Valve
		----- Note -----			792602 Spring-Governor (Red)	240	394358s	Filter-Fuel (White, 75 Microns)
		792022 Tube-Fuel Transfer (Nikki)(Pump Feed)			Used on Type No(s). 0115, 0119, 0121, 0127, 0382, 0393, 0439.			Used on Type No(s). 0113, 0125, 0138, 0142, 0144, 0381, 0382, 0426.
137♦♦281165s		Gasket-Float Bowl (Walbro)			692208 Spring-Governor (Green)			----- Note -----
137A ♦♦698781		Gasket-Float Bowl (Nikki)			Used on Type No(s). 0144.			298090s Filter-Fuel (Red, 150 Microns)
141	790902	Kit-Choke Shaft (Walbro)			691278 Spring-Governor (Platinum)	240A	691035	Filter-Fuel (Clear, 40 Microns)
141A	698778	Kit-Choke Shaft (Nikki)			Used on Type No(s). 0117.			Used on Type No(s). 0111, 0114, 0115, 0117, 0118, 0119, 0121, 0127, 0143, 0145.
141B	790903	Kit-Choke Shaft (Walbro)			690576 Spring-Governor (Gold)	261	697176	Screw (Control Slide)
		Used on Type No(s). 0114.			Used on Type No(s). 0142.	263	691083	Screw (Muffler Guard Retainer)
141C	793386	Kit-Choke Shaft (Manual Choke)			260902 Spring-Governor	265	691024	Clamp-Casing
		Used on Type No(s). 0145.			Used on Type No(s). 0138, 0381, 0426.	267	690804	Screw (Casing Clamp)
142	♦790025	Nozzle-Carburetor (Standard)	216	691840	Link-Choke	267A	695134	Screw (Casing Clamp)
143	790028	Nozzle-Carburetor (High Altitude)	216A	691281	Link-Choke			Used on Type No(s). 0142.
146	691639	Key-Timing			Used on Type No(s). 0119.			----- Note -----
187	791805	Line-Fuel (Formed)(10-1/4 Inches Long)(Cut to Required Length)			694335 Bracket-Control			792629 Screw (Casing Clamp)
					Used on Type No(s). 0127.	268	691025	Used on Type No(s). 0382, 0426, 0439.
187A	791806	Line-Fuel (Formed)(21 Inches Long)(Cut To Required Length)	222	694042	Bracket-Control			Casing-Control Wire (Cut To Required Length)
					----- Note -----	269	691026	Wire-Control (Cut To Required Length)
187B	791766	Line-Fuel (15 Inches Long)(Cut To Required Length)			694339 Lever-Governor Control	270	691027	Nut (Control Wire Casing)
187C	791745	Line-Fuel (23 Inches Long)(Cut To Required Length)	227	691374	Lever-Governor Control			
					----- Note -----			
188	691693	Screw (Control Bracket)			Used on Type No(s). 0127.			
192	691986	Adjuster-Rocker Arm						
202	691841	Link-Mechanical Governor						
203	691381	Crank-Bell						
		Used on Type No(s). 0119.						

★ Included in Engine Gasket Set-Ref. No. 358.

● Included in Carburetor Overhaul Kit-Ref. No. 121 or 121A.

♦ Included in Carburetor Gasket Set-Ref. No. 977 or 977A.

△ Included in Valve Gasket Set-Ref. No. 1095.

**Illustrations cover a range of engines. Parts shown without corresponding text may not be used on your specific engine.**



REF. NO.	PART NO.	DESCRIPTION	REF. NO.	PART NO.	DESCRIPTION	REF. NO.	PART NO.	DESCRIPTION
527	792167	Clamp-Tube Used on Type No(s). 0114, 0115, 0117, 0118, 0119, 0121, 0143, 0145.	635	691909	Boot-Spark Plug	759	697392	Pin-Counterweight
536	698973	Cleaner-Air Used on Type No(s). 0393, 0439.	643	697155	Retainer-Air Filter ----- Note ----- 792909 Retainer- Air Filter Used on Type No(s). 0127.	783	693713	Gear-Pinion
544	692034	Armature-Starter	654	690958	Nut (Carburetor)	788	699347	Bracket-Fuel Pump Used on Type No(s). 0119, 0127.
552	697144	Bushing-Governor Crank	676	393761	Deflector-Muffler (Side Out) Used on Type No(s). 0114, 0117, 0119, 0125, 0143, 0145.	789	698329	Harness-Wiring
559	697561	Screw (Remote Choke Stop)	676A	396903	Deflector-Muffler (Direct Out) Used on Type No(s). 0111.	789D	693050	Harness-Wiring Used on Type No(s). 0114, 0145.
562	691119	Bolt (Governor Control Lever)	677	690661	Screw (Muffler Deflector)	797	693167	Nut (Brush Retainer)
578	692306	Wire Assembly	687	697175	Slide-Control	801	691283	Cap-Drive
579	691029	Nut (Starter Cable)	688	690395	Cap-Friction	802	691286	Cap-End
584	697112	Cover-Breather Passage	689	691855	Spring-Friction	803		Housing-Starter (Not Serviced Separately, Order Motor 693551)
597	691696	Screw (Pawl Friction Plate)	689A	690529	Spring-Friction	823	698941	Screw (Muffler Adapter)
601	791850	Clamp-Hose (Zinc Plate)(Spring Wire)	691	*692407	Seal-Governor Shaft	830	691095	Stud-Rocker Arm
601A	691038	Clamp-Hose (Black)(Spring Steel)	692	691301	Spring-Detent	832	692361	Guard-Muffler Used on Type No(s). 0114, 0117, 0119, 0125, 0143, 0145.
608	695058	Starter-Rewind Used on Type No(s). 0113, 0114, 0115, 0117, 0119, 0121, 0125, 0127, 0138, 0143, 0145.	697	690372	Screw (Drive Cap)	832A	790293	Guard-Muffler Used on Type No(s). 0127.
613	691416	Screw (Muffler)	705	790561	Nut (Fuel Tank)	836	690367	Screw (Muffler Guard)
613A	691678	Screw (Muffler)	718	690959	Pin-Locating	842	*691031	Seal-O Ring (Dipstick Tube)
613B	690297	Screw (Muffler)	729	691335	Clip-Wire (Wire Retainer)	843	697158	Sleeve-Lever
614	691620	Pin-Cotter	729A	691224	Clip-Wire (Starter Motor)	847	790442	Dipstick/Tube Assembly Used on Type No(s). 0113, 0125, 0138, 0142, 0144, 0381, 0382, 0393, 0426, 0439.
616	692012	Crank-Governor	741	697128	Gear-Timing			----- Note ----- 790443 Dipstick/Tube Assembly Used on Type No(s). 0111, 0114, 0115, 0117, 0118, 0119, 0121, 0127, 0143, 0145.
617	*692138	Seal-O Ring (Intake Manifold)	750	790832	Screw (Oil Pump Cover)	851	692424	Terminal-Spark Plug
621	692310	Switch-Stop Used on Type No(s). 0114, 0117, 0119, 0143, 0145.	757	793242	Link-Counterweight Used on Type No(s). 0111, 0113, 0114, 0115, 0118, 0119, 0121, 0125, 0138, 0144, 0145, 0393, 0439.	864	697346	Adapter-Muffler Used on Type No(s). 0111, 0114, 0115, 0117, 0118, 0119, 0121, 0125, 0127 0138, 0143, 0145.
633	690597	Seal-Choke/Throttle Shaft Used on Type No(s). 0114, 0145.	758	697391	Counterweight Used on Type No(s). 0111, 0113, 0114, 0115, 0118, 0119, 0121, 0125, 0138, 0144, 0145, 0393, 0439.			
634	690802	Spring/Seal Assembly (Walbro)						
634A	698779	Spring/Seal Assembly (Nikki)						

\* Included in Engine Gasket Set-Ref. No. 358.

● Included in Carburetor Overhaul Kit-Ref. No. 121 or 121A.

◆ Included in Carburetor Gasket Set-Ref. No. 977 or 977A.

△ Included in Valve Gasket Set-Ref. No. 1095.

**Illustrations cover a range of engines. Parts shown without corresponding text may not be used on your specific engine.**

# 217800

REF. NO.	PART NO.	DESCRIPTION	REF. NO.	PART NO.	DESCRIPTION	REF. NO.	PART NO.	DESCRIPTION
868	★△690968	Seal-Valve	994	392390	Arrestor-Spark Used on Type No(s). 0127.	1044	698139	Screw (Flywheel)
877	393456	Wire/Connector- Alternator (Dual Circuit)	1005	794439	Fan-Flywheel (Used After Code Date 07040800).	1051	691265	Ring-Retaining
877A	393814	Wire/Connector- Alternator (DC Only)	1005A	794440	Fan-Flywheel (Used Before Code Date 07040900).	1054	280275	Tie-Cable
878	398661	Harness-Alternator (Dual Circuit)	1017	690770	Screen-Oil Pump Used on Type No(s). 0111.	1058	276344	Operator's Manual
883	★692236	Gasket-Exhaust	1022★△272475s	Gasket-Rocker Cover	1059	698516	Kit-Screw/Washer	
914	691108	Screw (Rocker Cover)	1023	791079	Cover-Rocker (Used After Code Date 05013100).	1070	690372	Screw (Flywheel Fan) (Used Before Code Date 07040900).
918	791851	Hose-Vacuum (Molded)	1024	499054	Pump-Oil Used on Type No(s). 0111. (Used Before Code Date 07051700).	1070A	690363	Screw (Flywheel Fan) (Used After Code Date 07040800).
943	★690589	Seal-O Ring (Oil Pump Cover)	1024A	794644	Pump-Oil Used on Type No(s). 0111. (Used After Code Date 07051600).	1090	691293	Retainer-Brush
950	691657	Screw-Float Bowl (Bottom Of Bowl)	1026	697395	Rod-Push (Exhaust)	1091	691333	Cap-Limiter
957	792647	Cap-Fuel Tank (Plastic)	1027	492932s	Filter-Oil Used on Type No(s). 0111.	1095	691581	Gasket Set-Valve
958	698183	Valve-Fuel Shut Off (Plastic) Used on Type No(s). 0111, 0138.	1029	691751	Arm-Rocker	1119	691183	Screw (Alternator)
965	499613	Cover-Oil Pump Used on Type No(s). 0111.	1034	690822	Guide-Push Rod	1127	695407	Screw (Float Bowl)(Nikki)
967	697292	Filter-Pre Cleaner	1035	693784	Shaft-Pump Used on Type No(s). 0111. (Used Before Code Date 07051700).	1136	690278	Screw (Control Bracket)(High Speed Control)
968	697420	Cover-Air Cleaner (Black) ----- Note ----- 697422 Cover-Air Cleaner (Red)	1036	1036	Label-Emissions (Available From A Briggs & Stratton Authorized Dealer)	1146	793380	Screw (Choke Shaft)
972	792168	Tank-Fuel (Plastic) Used on Type No(s). 0114, 0115, 0117, 0118, 0119, 0121, 0143, 0145.	1040	698368	Plate-Trim Used on Type No(s). 0111, 0118, 0142, 0144, 0381, 0382, 0426.	1263	697124	Reed-Breather
975	495933	Bowl-Float (Walbro)				1264	697104	Screw (Breather Reed)
975A	698783	Bowl-Float				1266	★691917	Seal-O Ring (Intake Elbow)
977	690192	Gasket Set-Carburetor (Walbro)				1266A	★697123	Seal-O Ring (Intake Elbow)
977A	790032	Gasket Set-Carburetor (Nikki)				1267	697419	Latch-Blower Housing (Black)
987	●691326	Seal-Throttle Shaft (Walbro)				1270	697156	Plug-AVS Counterweight Used on Type No(s). 0111, 0113, 0114, 0115, 0118, 0119, 0121, 0125, 0138, 0144, 0393, 0439. ----- Note ----- 793243 Plug-AVS Counterweight Used on Type No(s). 0145.
987A	●698777	Seal-Throttle Shaft (Nikki)				1319	794467	Label-Warning

★ Included in Engine Gasket Set-Ref. No. 358.

● Included in Carburetor Overhaul Kit-Ref. No. 121 or 121A.

◆ Included in Carburetor Gasket Set-Ref. No. 977 or 977A.

△ Included in Valve Gasket Set-Ref. No. 1095.

**Illustrations cover a range of engines. Parts shown without corresponding text may not be used on your specific engine.**