

# G. PULLEY & TENSION PULLEY

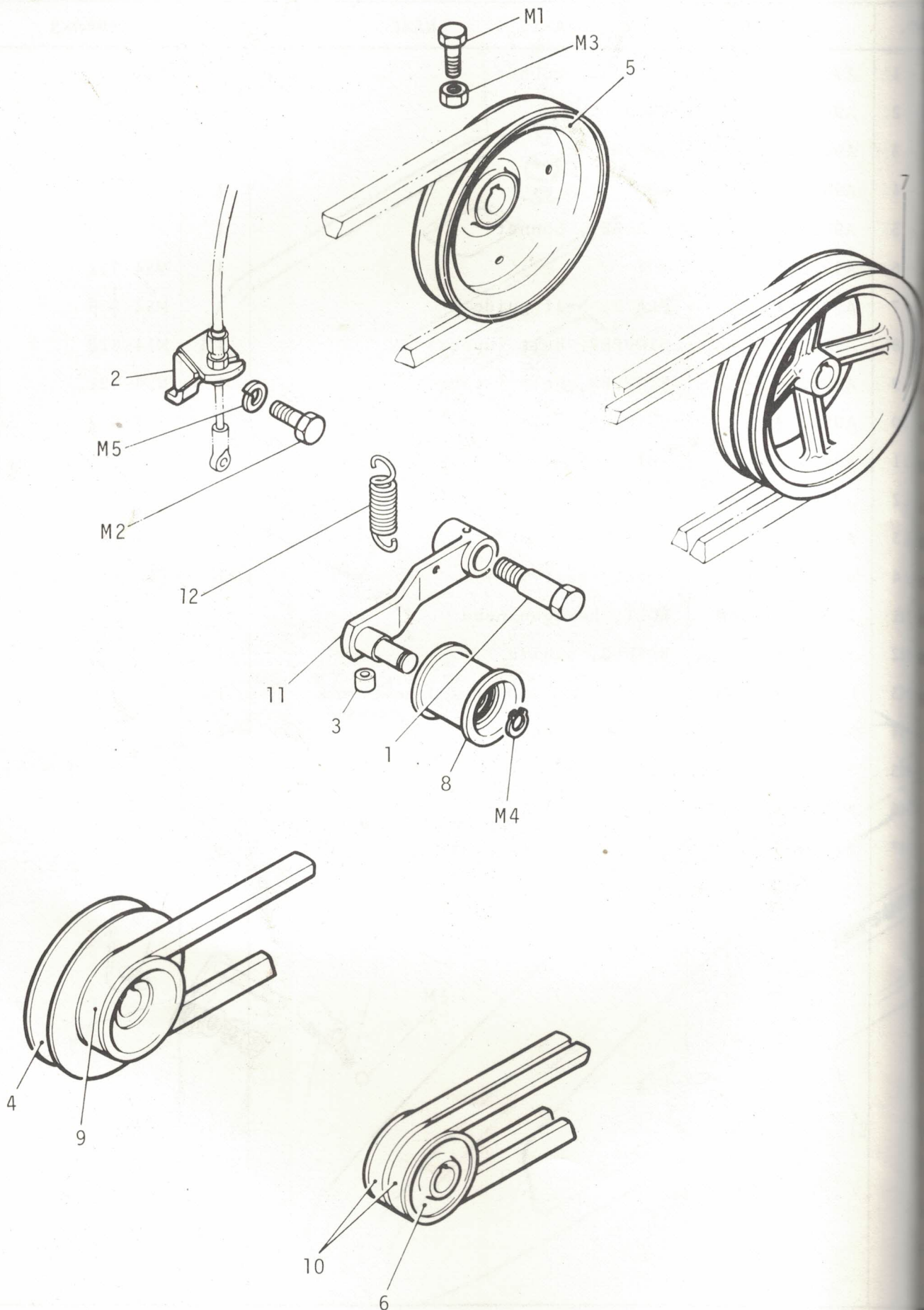

# 6. PULLEY & TENSION PULLEY

PARTS NO.	PARTS	NAME	Q'TY	REMARKS
8B06294	BOLT	#7701 ~	1	MS4-816
8B06295	BRACKET, tension		1	MS4-818
8B06296	BOOT, rubber	#2001 ~	1	MS4-825
8B06350	PULLEY, engine		1	69φ, 113.5φ MS4-812a MS4-812a 144φ, 103φ MS4-811a 59φ Option MS4-814
8B06401	PULLEY, engine		1	MS4-814
8B06402	PULLEY, main	#20461 ~ old NO. A906292 A932503T	11	152φ Option MS4-813 M8-817a
8B06421	PULLEY, tension		1	LB ~ SB 33" A33" Option #20461 old NO. A906291 *assy
8B06465	V-BELT		1	
8B0651P	V-BELT		2	
8B06422	ARM, tension		1	
8B06297	SPRING		1	
8B06408x025M	BOLT, hexagon head		1	
8B06410x025M	BOLT, hexagon head		1	
8B06408x00M	NUT, hexagon		1	
8B06212x00P	RING, retaining-C type		1	
8B06180x00M	WASHER, spring lock		1	SRS-12

